



fabuwood®

*Customization
Brochure
2026*



Semi-custom that fully closes deals.

Give your customers more reasons to say yes with semi-custom, hand-crafted cabinetry shaped by data-backed insight, market intelligence, pro-tested performance, and engineered precision.

The following pages highlight our standard custom offerings. For projects that demand greater personalization, select styles are available in custom sizing, with additional modifications and customization options to meet any specification.

Carry what sells. Offer what stands out.

Contents

7	Custom Items
15	Cabinet Modifications
23	Cabinet Chase Cut-Outs
27	Frameless Upgrades
31	Product Customizations
47	Customization Gallery

Custom Items







Custom Cabinets

- Available for Allure, Illume, and Ovela.
- Choose from 24 different configurations of Base, Drawer Base, Tall, Tall Oven, and Wall Cabinets.
- Specify Dimensions, including: Width, Height, Depth, and Toe Kick Height (if applicable).
- On Custom Tall & Tall Oven Cabinets, specify Upper Section Height.
- Customize further by choosing Shelf Quantity, Shelf Depth, or No Shelves/Shelf Clip Holes
- Create the ultimate configuration by including Accessories such as Roll-Out Drawers, or additional modifications such as Matching Interior.

Custom Base Cabinet



SKU# CUSTOM BASE



Available configurations:

- Single Door & Single Drawer
- Double Door & Single Drawer
- Double Door & Double Drawer
- Single Full Door
- Double Full Door
- Single Door Single False Front Sink Base
- Double Door Single False Front Sink Base
- Double Door Double False Front Sink Base
- Farm Sink
- Microwave
- Oven
- No Door

Custom Drawer Base



SKU# CUSTOM DRAWER BASE



Available configurations:

- 1 Drawer
- 2 Drawer
- 3 Drawer
- 4 Drawer

Custom Wall Cabinet



SKU# CUSTOM WALL



Available configurations:

- Single Door
- Double Door
- No Door Wall

Custom Tall Oven Cabinet

SKU# CUSTOM TALL OVEN



Available configurations:

- Single / 3 Drawer
- Combo / 2 Drawer
- Double / 1 Drawer

Custom Tall Cabinet

SKU# CUSTOM TALL



Available configurations:

- Single Door
- Double Door
- No Door
- Single Door Lower Only
- Single Door Upper Only
- Double Door Lower Only
- Double Door Upper Only

Custom Door



SKU# CUSTOM DOOR

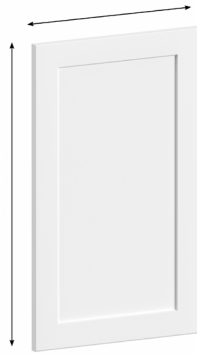

Create a custom-sized Door.

- Specify the following dimensions: Width & Height
 - Max: 24" x 84" / 48" x 24" *
- Specify Center Panel configurations:
 - With Standard Center-Panel / Prepped for Glass
- Specify Hinging options:
 - With Hinge Holes / Without Hinge Holes / With Hinge Holes On Top As Lift Up

Available for Framed & Frameless Series Cabinets.

Custom Drawer Front



SKU# CUSTOM DRAWER FRONT

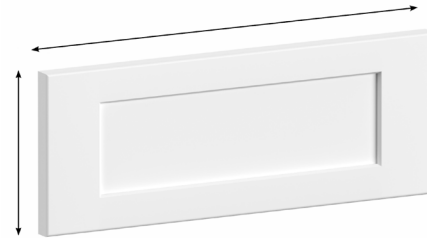

Create a custom-sized Drawer Front.

- Specify the following dimensions: Width & Height
 - Max: 48" x 24" / 48" x 24" *
 - Drawer fronts under a minimum height receive Reduced Top & Bottom Rails (depending on Door Style).

Available for Framed & Frameless Series Cabinets.

Custom Deco Door



SKU# CUSTOM DECO DOOR



Create a custom sized Decorative Door for Panel-Ready Appliance or Wainscot Panel.

- Specify the following dimensions: Width & Height
 - Max: 42" x 84" / 48" x 42"

Available for Framed & Frameless Series Cabinets.

Custom Deco Appliance Frame

SKU# CUSTOM DECO APPLIANCE FRAME

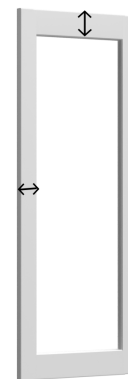

Create a custom-sized Decorative Door, tailored for a Panel-Ready Glass Door Appliance.

- Specify the following dimensions: Width & Height
 - Max: 42" x 84" / 48" x 42"

Please note: Custom quote required.

Available for Framed Series Cabinets only.

Custom Column



SKU# CUSTOM-CLM

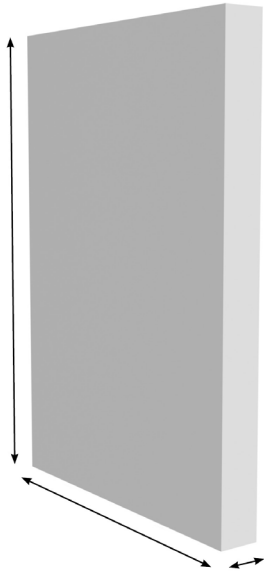

Enter custom sizes to create column up to 96".
Available for Framed & Frameless.

Over-Sized Custom Column



SKU# CUSTOM CLM-OS

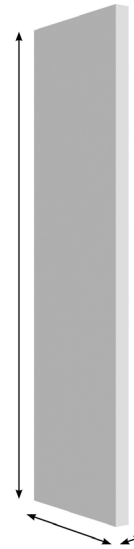

Enter custom sizes to create column between 96" - 120".
Available for Framed only.

Create Wall Return

SKU# CREATE-RETURN WALL

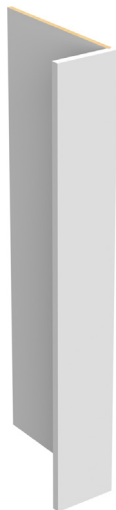

Create a return wall filler up to 6"W x 15"D x 42"H
Please note: Custom quote required.

Create Tall Return

SKU# CREATE-RETURN TALL



Create a return tall filler up to 6"W x 30"D x 120"H.
Please note: Custom quote required.

Add Filler to back of Column

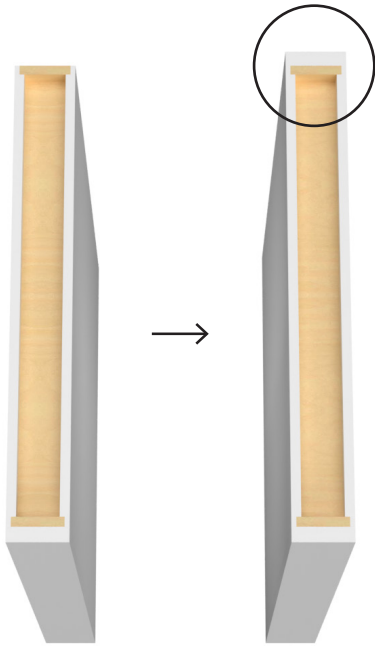

Fabuwood can apply a filler to the back of a column, finishing it on both ends.
Please note: Custom quote required.

Cabinet Modifications





Reduce Depth of a Wall Cabinet (min. depth 3")



MOD# CUT-WALL

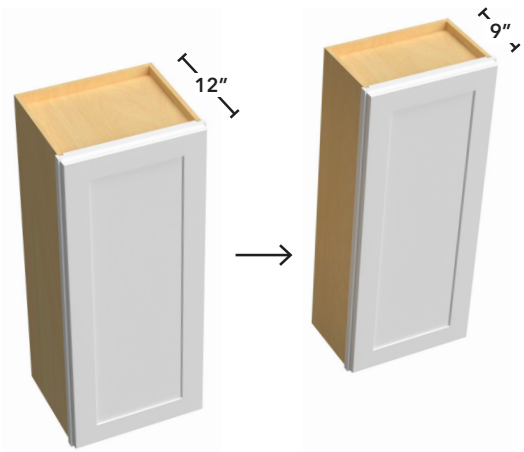

Wall cabinets have a standard depth of 12". Generally, modifications will be made in 3" increments, but can also be cut to custom sizes such as 5", 5-1/4", or 5-1/2" deep. Wall cabinets can be cut to any size, with a minimum depth of 3".

Please note: For a No Door wall cabinet, wood shelves will be provided instead of glass shelves.

Available for Framed & Frameless Series cabinets.

Increase Depth of Wall Cabinet (max. depth 30")



MOD# INCREASE-WALL

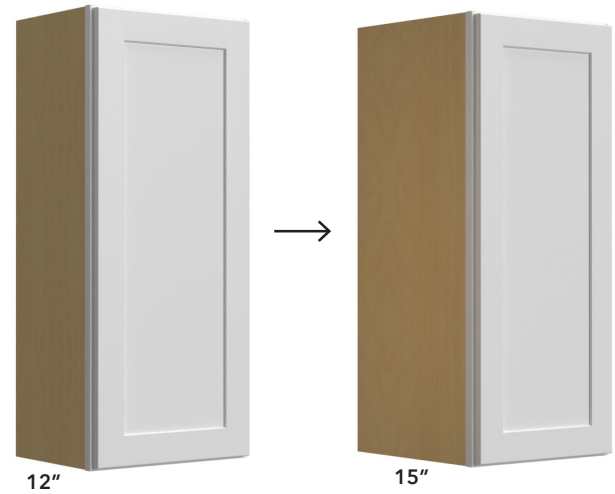

Fabuwood's standard wall cabinet are 12" deep. Cabinet depth can be increased up to 30".

Please note: For a No Door wall cabinet, wood shelves will be provided instead of glass shelves.

Available for Framed & Frameless Series cabinets.

Reduce Width of a Wall Cabinet

MOD# CUT-WIDTH WALL

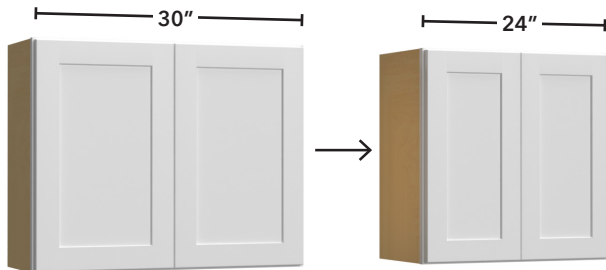

Please note: May require custom doors.

Available to enter via EZ-Pricing for Frameless Cabinets. Framed Cabinets requires Custom Quote.

Reduce Height of a Wall Cabinet

MOD# CUT-HEIGHT WALL

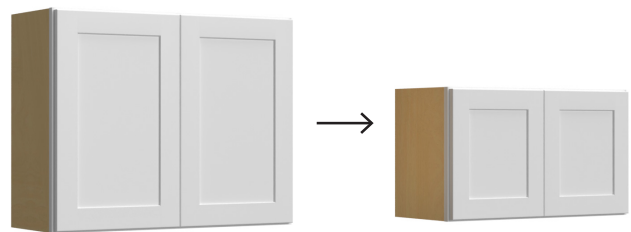

Please note: May require custom doors.

Custom quote required.

Available to enter via EZ-Pricing for Frameless Cabinets. Framed Cabinets requires Custom Quote.

Cut Height of RHA Hood

(suggested min. height 24")



Please note: Requires custom doors.
Custom quote required.
Available for Framed Allure Cabinets.

Reduce Depth of Base Cabinet (min. depth 12")



MOD# CUT-BASE

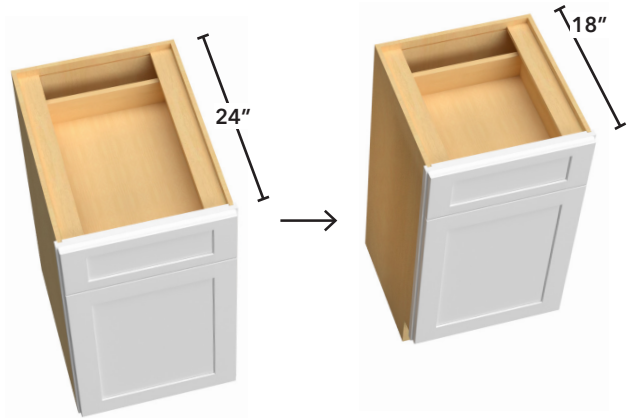

The standard depth of a base cabinet is 24" deep. Generally, customizations are done in 3" increments, but can also be done to any custom size, such as 16", 17", or even 17½" deep. Base cabinet must have a minimum depth of 12". The drawer box will be cut to 3" less than the cabinet depth. To accommodate the drawer slides, the drawer box can only be cut in 3" increments.

Available for Framed & Frameless Series cabinets.

Increase Depth of Base Cabinet



MOD# INCREASE-BASE

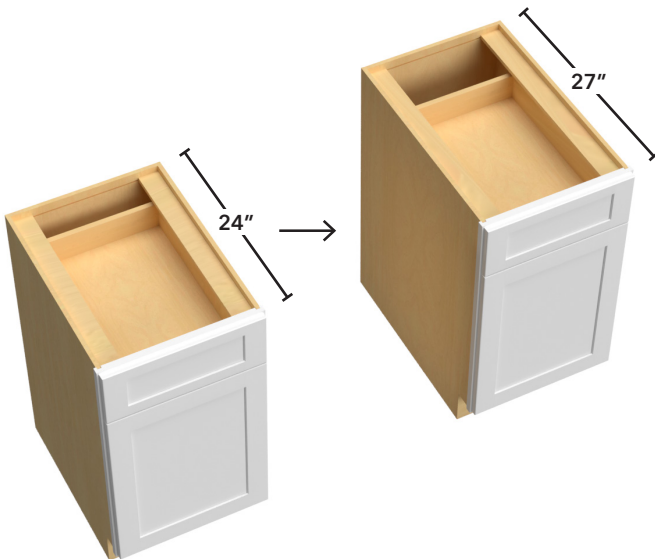

Cabinet depth can be increased to any size. The drawer depth will remain 21".

Available for Framed & Frameless Series cabinets.

Reduce Width of a Base Cabinet

MOD# CUT-WIDTH BASE



Available to enter via EZ-Pricing for Frameless Cabinets.
Framed Cabinets requires Custom Quote.

Reduce Height of Base Cabinet



MOD# CUT-BASE HEIGHT

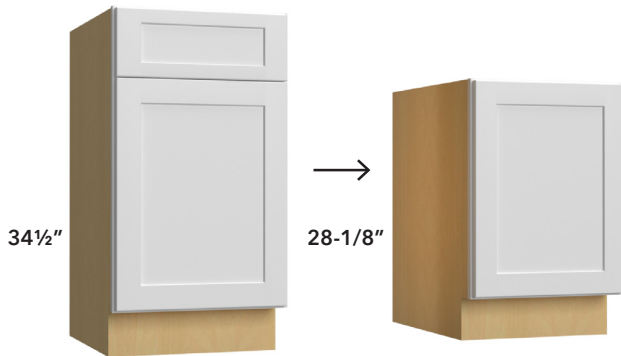

The height of a base cabinet can be cut right above the door, eliminating the drawer. Available on base cabinets with standard drawer front height.

The total height will be:

- Framed 28-1/8"
- Frameless Illume 27-11/16"H
- Frameless Ovela 28"H
- Value - Quest 28-1/2"

Available for Framed and Frameless Series Cabinets.

Reduce Toe Kick Height



MOD# CUT-TK



Fabuwood can reduce the height of the toe kick in 1/4" increments or remove the toe kick completely.

Please note: Cabinet is not designed to use as a wall hung cabinet.

Available to enter via EZ-Pricing for Framed & Frameless Series Ovela Cabinets.

Reduce Depth of Drawer Base Cabinet (min. depth 12")



MOD# CUT-DBASE

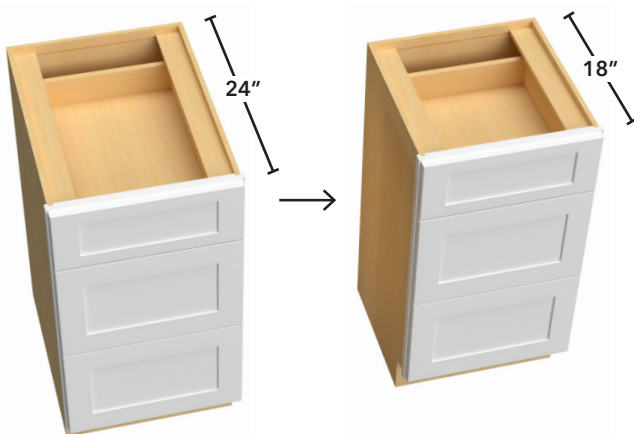

Fabuwood can cut the depth of a drawer base cabinet to customer specifications. Please note the depth of all three drawer boxes will be 3" less than the cabinet box. For example, when a cabinet is cut to 18" deep, the drawer boxes and slides will be 15" deep.

Available for Framed & Frameless Series cabinets.

Reduce Depth of Sink Base Cabinet (min. depth of 4")



MOD# CUT-SBASE

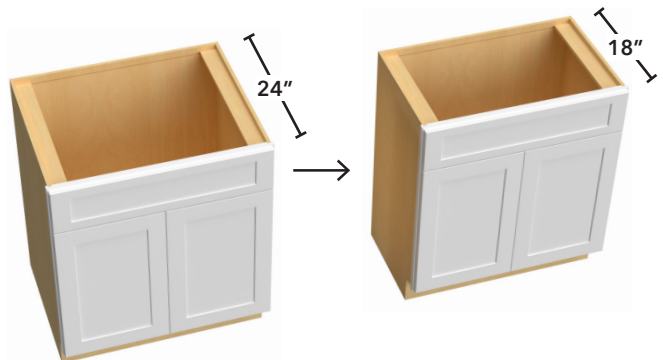

Sink base cabinets can be cut to a minimum depth of 4". Generally, customizations are done in 1/4" increments, but can also be modified to any custom size.

Available for Framed & Frameless Series cabinets.

Reduce Depth of a Tall Cabinet (min. depth of 4")



MOD# CUT-TALL

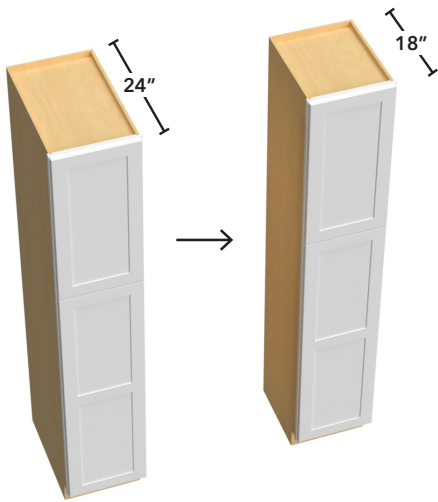

Tall cabinets are available in 12" and 24" deep. Fabuwood can cut the depth of a tall cabinet to customer specifications with a minimum depth of 4".

Available for Framed & Frameless Series cabinets.

Increase Depth of Tall Cabinet (max. depth 30")



MOD# INCREASE-TALL

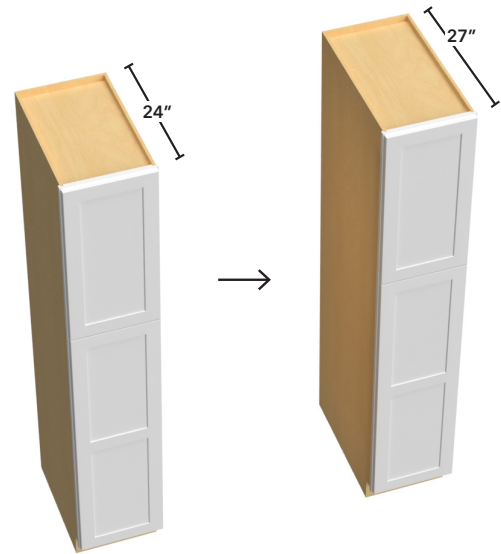

Fabuwood offers 12"D and 24"D tall cabinets. Fabuwood can increase the depth of any tall cabinet up to 30"D.

Available for Framed & Frameless Series cabinets.

Reduce Width of a Tall Pantry

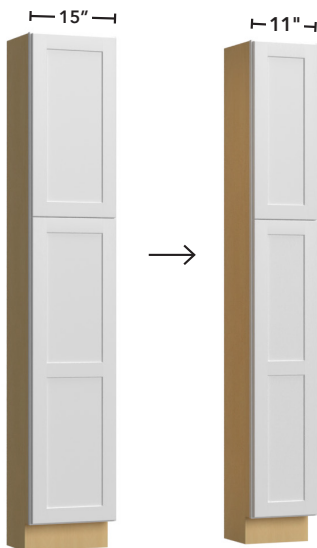

Available to enter via EZ-Pricing for Frameless Series Cabinets. Framed Series Cabinets requires Custom Quote.

Reduce Width of Oven Cabinet

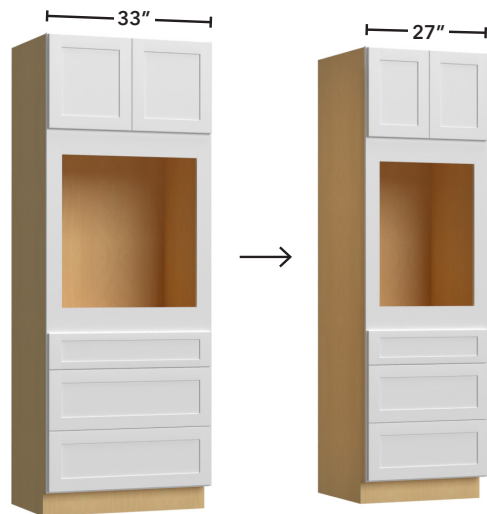

Please note: May require custom doors, drawer fronts & drawer boxes. Custom quote required.

Custom Tall Oven Cabinets are now available in widths up to 30" using the Custom Tall Oven SKU in EZ-Pricing.

Available to enter via EZ-Pricing for Frameless Series Cabinets. Framed Series Cabinets requires Custom Quote.

Reduce Height of Tall Pantry or Oven Cabinet

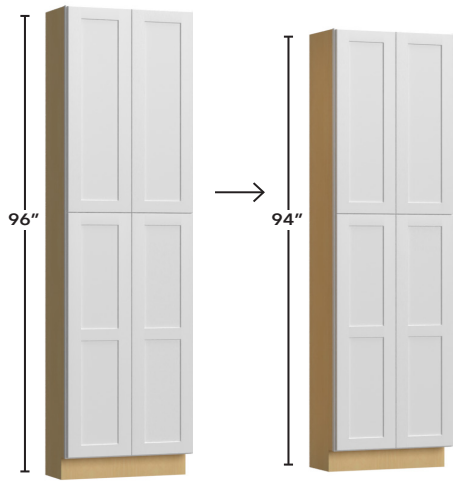

Please note: May require custom doors. Custom quote required.

You can now enter Custom Tall & Custom Tall Oven cabinets online for heights 72" - 96"H.

Available to enter via EZ-Pricing for Frameless Series Cabinets. Framed Series Cabinets requires Custom Quote.

Reduce Depth of KD30 Cabinet (min. depth 12")



MOD# CUT-KD30

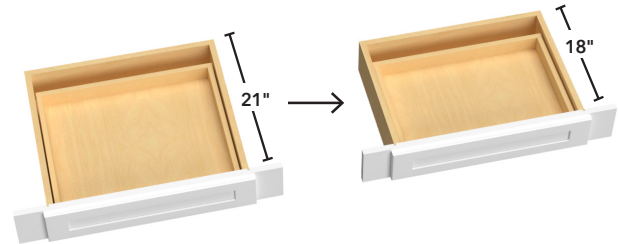

Fabuwood can modify the depth of any knee drawer in 3" increments. The drawer box will be 3" less than the cabinet depth. For example: if a base cabinet is cut to 18" deep, the drawer box and slides will be 15" deep.

Available for Framed Series cabinets.

Reduce Depth of a Roll-Out Drawer

MOD# CUT-ROD

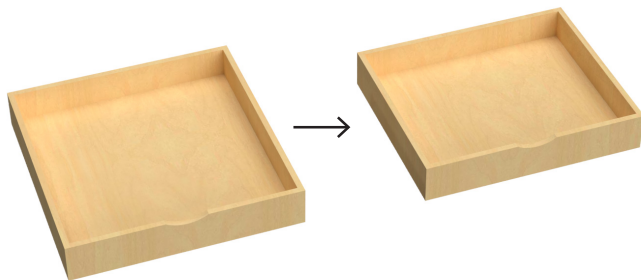

Reduce the depth of a roll-out drawer when a cabinet is less than 24" deep.

The rollout drawer boxes will be cut to 3" less than the cabinet depth. To accommodate the drawer slides, the drawer box can only be cut in 3" increments. The minimum depth of a base cabinet must be 12" for rollout application.

Please note: The back of the rollout will no longer be dovetail.

Available for Framed & Frameless Series cabinets. Custom quote required.

Reduce Depth of a Column



MOD# CUT-COLUMN

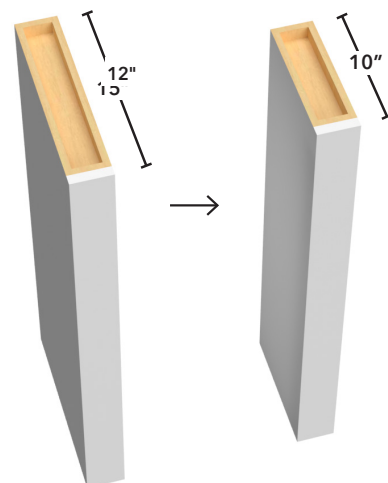

Columns can be reduced to any depth in 1/4" increments.

Available for Framed & Frameless Series cabinets.

Cut Width of Filler on Return Panel, and Finished Cut Side



MOD# CUT-RETURN WIDTH

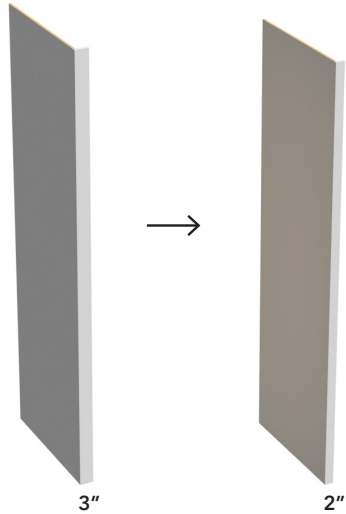

Available for Framed & Frameless Series cabinets.

Cut Panel



MOD# CUT-PANEL

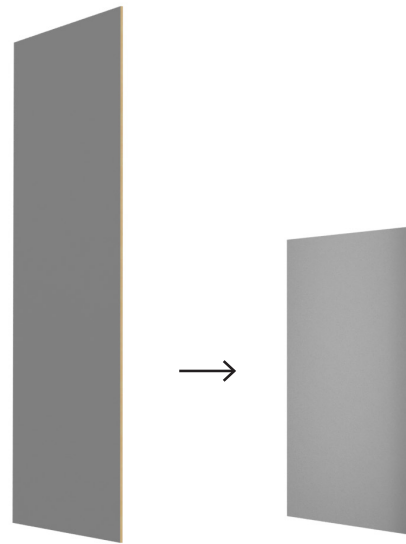

Customer can also add matching color edge-band for Fabuwood to apply, or to ship loose.

Available for Framed & Frameless Series cabinets.

Cut 2" From 96" Molding



MOD# CUT 2" FROM 96" MOLDING

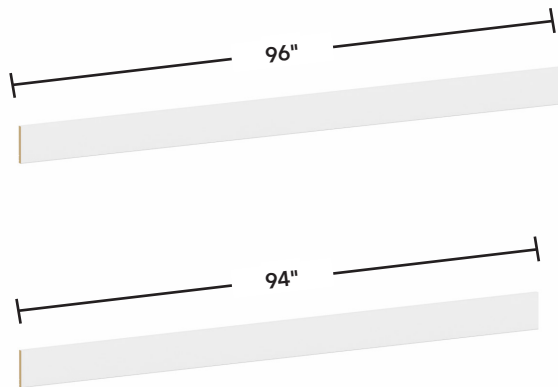

Cut molding to 94". Available for any style molding over 95". Available for Framed & Frameless Series cabinets.

Cabinet Chase Cut-Outs





Create Chase in Base Cabinet



MOD# CHASE-BASE

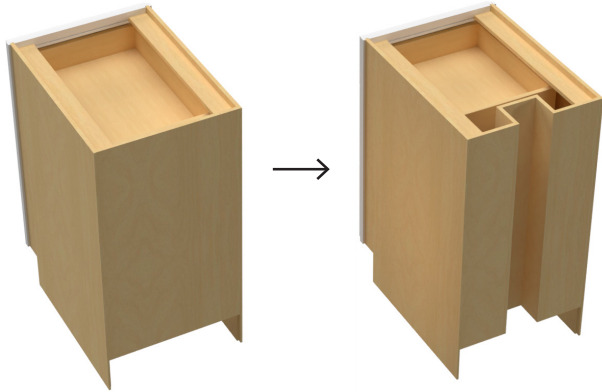

Fabuwood can modify any base cabinet to have a vertical pipe chase. The Shelf will be modified to accommodate the chase and the Drawer Depth is reduced to be 3" from the chase.

Please note: Customer must provide drawing.
Available Framed & Frameless Series Cabinets.

Create Chase in Drawer Cabinet



MOD# CHASE-DBASE

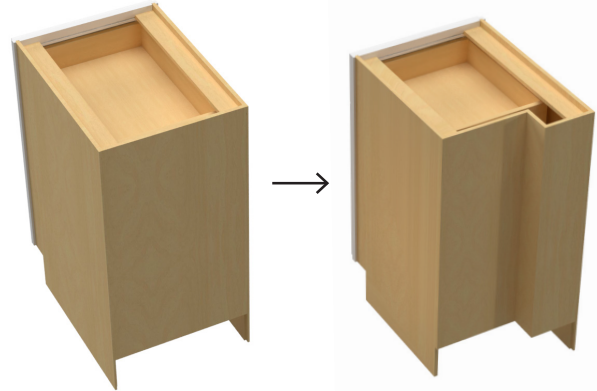

Fabuwood can modify any drawer base cabinet to have a vertical pipe chase. Drawer Depth is reduced to be 3" from the chase.

Please note: Customer must provide drawing.
Available Framed & Frameless Series Cabinets.

Create Chase in Corner Cabinet



MOD# CHASE-CORNER

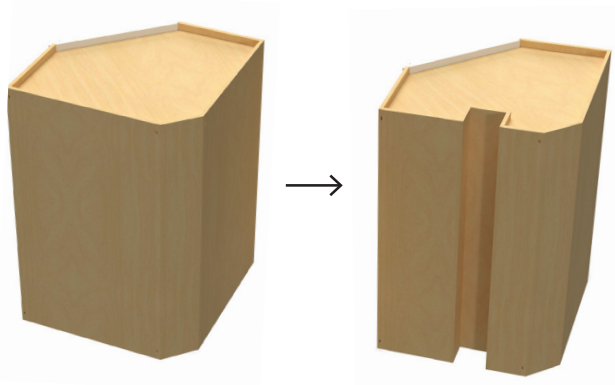

Fabuwood can modify any corner cabinet to have a vertical pipe chase. The shelf will be modified to accommodate the chase.

Please note: Customer must provide drawing.
Available Framed & Frameless Series Cabinets.

Create Chase in Wall Cabinet



MOD# CHASE-WALL

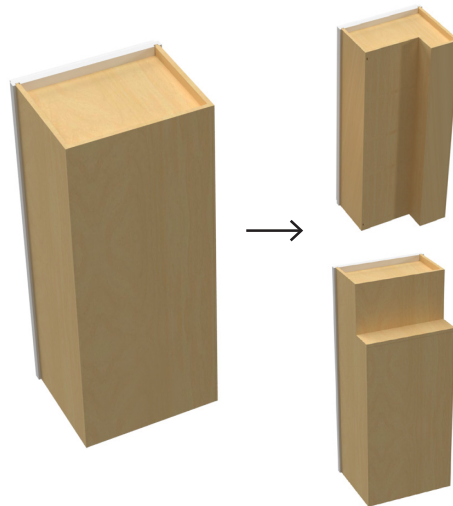

Fabuwood can modify any wall cabinet to have a vertical or horizontal pipe chase. The shelving will be modified to accommodate the chase.

Please note: Customer must provide drawing.
Available Framed & Frameless Series Cabinets.

Create Chase in a Tall Cabinet



MOD# CHASE-TALL

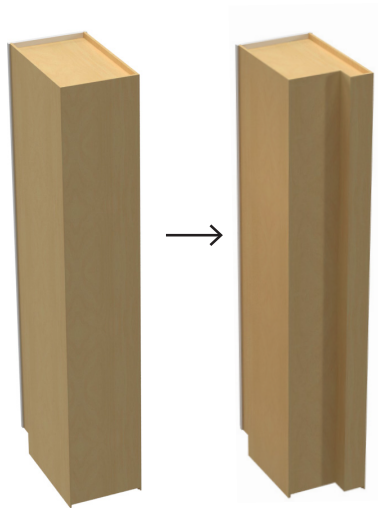

Fabuwood can modify any tall cabinet with a vertical and/or horizontal. The shelving will be modified to accommodate the chase.

Please note: Customer must provide drawing.
Available Framed & Frameless Series Cabinets.

Frameless Upgrades







Frameless Illume and Ovela Series can be customized with upgrades that refine your space and elevate everyday use.

Extended Door and Finished End



MOD# EXTENDED DOOR (& SPECIFY FINISHED END)



Available only for Frameless Illume & Ovela Series door styles, Extended Door & Extended Side are available two sizes:
3/4" overhang or 1 1/2" overhang

Extended Door Without Finished End



MOD# EXTENDED DOOR
(FINISHED END NOT SPECIFIED)



Available only for Frameless Illume & Ovela Series door styles, Extended Door & Extended Side are available in two sizes:
3/4" overhang or 1 1/2" overhang

Matching Edge Band



MOD# EBAND-MATCH BOX & EBAND-MATCH SHELF



Edge band that blends in with the door color for a sleek, polished look that ties your whole space together.

Choose to matching edge band for the cabinet box, shelves, or both.

Available for Frameless Series cabinets

Push To Open (Tip-On)



MOD# PUSH TO OPEN DOORS
& PUSH TO OPEN DRAWERS



The Push-To-Open system with BLUM Tip-On hardware offers a clean, handle-free look by allowing doors and drawers to open with a gentle press. It's a great option for modern, minimalist kitchens or spaces where sleek, uninterrupted surfaces are desired.

*Push To Open Doors/Drawers upgrades are not available for Cabinets with Pull-Out accessories.

Available for Frameless Series cabinets

Product Customizations

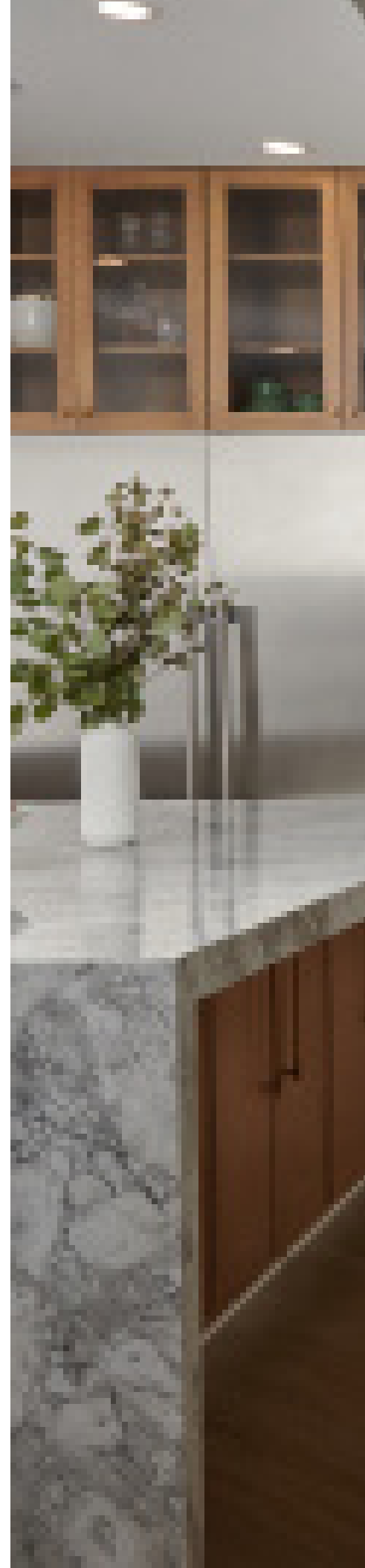



Attach Toe-Kick on a Wall Cabinet



MOD# ATTACH-TK

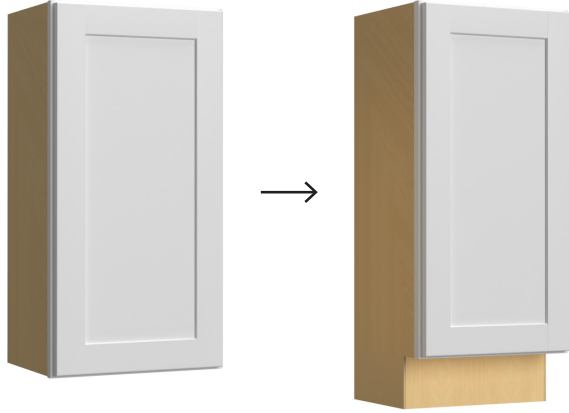

Fabuwood can modify a wall cabinet into a base cabinet by applying a toe-kick.
Please note: Customer needs to specify exposed sides.
Available for Framed Series cabinets.

Close Open Section of a Blind Cabinet



MOD# CLOSE-BLIND



Fabuwood can close the open section of a blind wall or base cabinet by adding a 1/4" panel on the inside of the frame.

Please note: Fabuwood can order and install any accessory for a blind cabinet. Customer must provide the model number.

Available for Framed & Frameless Series cabinets.

Close the Panel Opening of an Oven Cabinet



MOD# CLOSE FRONT-OC



Fabuwood can close the open panel of a base microwave, base oven, tall oven, or a wall microwave cabinet by adding 3/4" plywood to the inside of the frame.

Available for Framed Series cabinets.

Create Base Microwave Cabinet from Drawer Base



MOD# CREATE-BMC



Fabuwood can modify a drawer base to create a microwave base. To fulfill this modification, Fabuwood will remove the top two drawers, install a support shelf on top of the bottom drawer, and apply a full flat panel to the front.

Please note: Full flat panel to be cut on the job site to accommodate the microwave.

Available for Framed & Frameless Series cabinets

Create Base Oven Cabinet from a Base Cabinet



MOD# CREATE-BOC



Fabuwood can modify a base to create an oven base. To fulfill this modification, the top drawer and doors are removed, a full flat panel is applied to the front.

Please note: Full flat panel to be cut on the job site to accommodate the oven.

Available for Framed & Frameless Series cabinets.

Create Square Bottom Shelf for Open End Cabinet



MOD# CREATE-SQ BOTTOM

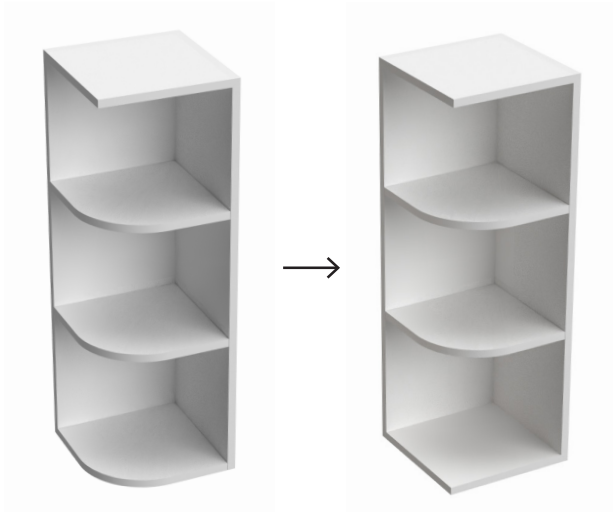

Add a square bottom to an open end, to apply light rail molding.

Available for Framed Series Cabinets.

Create Arched Valance from a Filler

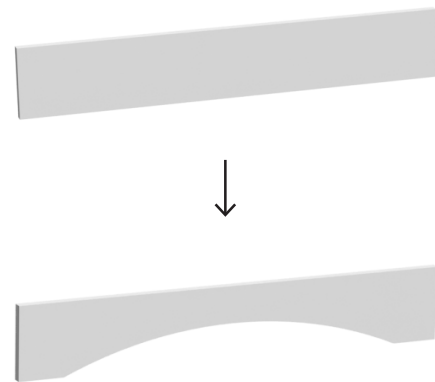

The valance will be 5-1/2" high and can be up to 96" long. This is also used for a base toe kick to create a furniture look. Please note: Custom quote required.

Available for Framed Series Cabinets.

Fill Hinge Holes with Touch-Up (seam will still be visible)



MOD# FILL HINGE SEAM



Please Note: Hinges will be removed; Door Set will ship loose.

Available for Framed Series Cabinets.

Flush Toe Kick of Cabinet



MOD# FLUSH-TOE KICK



Fabuwood can modify the toe kick by bringing it forward to be flushed with the face frame.

Available for Framed & Frameless Ovela Series Cabinets.

Flush Bottom Panel of Wall Cabinet



MOD# FLUSH-WALL BOTTOM

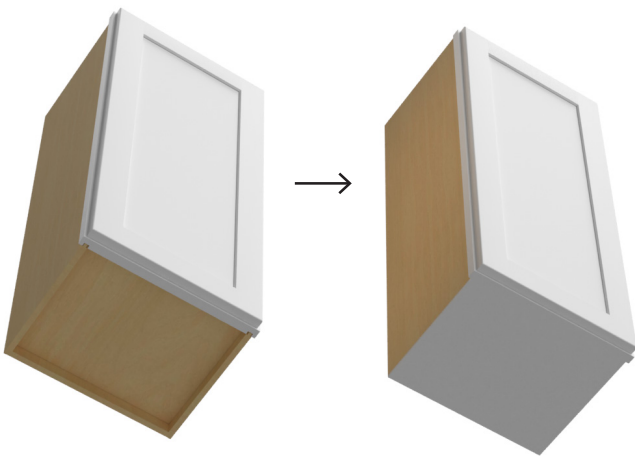

Available for Framed Series Cabinets.

Create Full-Door Base Cabinet from Standard Base Cabinet

MOD# FULL-DOORS



Available for Framed Base, Sink Base cabinets 42 - 42 inches wide and Blind Base cabinets.

Please note: Custom Quote Required.

Install Door-Mounted Pull-Out Wood Hamper in Cabinet



MOD# HAMPER



To create a hamper cabinet from a base cabinet, a door-mounted wood hamper is attached using undermount slides. Hamper is 18" high. This includes hamper box only, and does not include cloth liner or plastic bin accessories.

Available for Framed & Frameless Series Cabinets.

Full Cut-Out on Microwave Cabinet

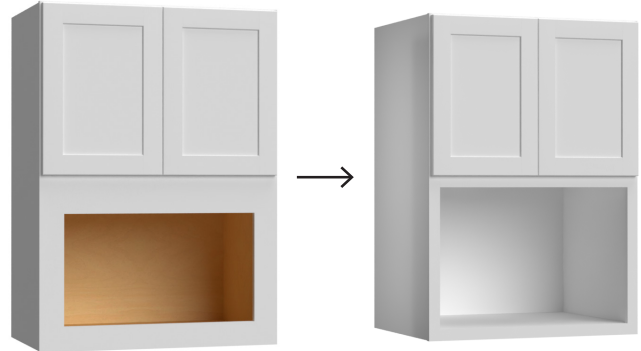

Fabuwood can create a full cut out by cutting the full frame, leaving a 1-1/2" rather than 3" wide stiles and rails.

Please note: Customer needs to specify match-interior when ordering. Custom quote required.

Available for Framed Series Cabinets.

Recess Toe Kick on Base Cabinet



MOD# RECESS-TK



Fabuwood can recess the toe kick of any base cabinet by 3" increments from the following options: Left, Right, Back or a combination of all three.

Available on Framed Series & Frameless Ovela Series Cabinets.

Full Depth Shelf



Fabuwood can create a full depth shelf for any base or tall cabinet.

Please note: Available for Framed & Frameless Series cabinets. Custom quote required.

Custom Base Cabinets can now be entered with Full-Depth Shelf on EZ-Pricing Online

Insert Broom Divider



MOD# INSERT BROOM DIVIDER



Divide the lower section of a pantry to use as a broom closet. A cutout will be made in the center fixed shelf to allow space for the broomstick.

Broom portion to be 6" wide. Specify Left or Right Side.

Available for Framed Series cabinets.

Insert Tray Dividers in a Wall Cabinet



MOD# INSERT DIVIDER

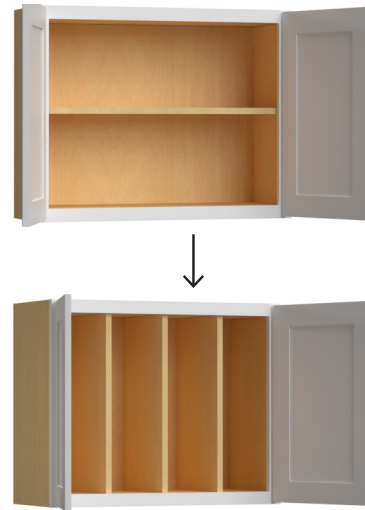

Insert 1/2" vertical tray dividers in a standard wall from 9"W - 36"W.

Other configurations available through Custom Quotes.

Available for Framed Series cabinets.

Insert Tray Dividers in a Base Cabinet



MOD# INSERT DIVIDER



Insert 1/2" vertical tray dividers in a standard base cabinet from 9"W - 36"W.

Other configurations available through Custom Quotes.

Available for Framed Series cabinets.

Invert Base Cabinet Frame



MOD# INVERT FRAME-BASE



Using a standard base cabinet, Fabuwood can invert the frame featuring a door at the top and a drawer on the bottom. A fixed shelf with a front rail is also inserted above the drawer.

When your selected SKU in vanity depth is not available, an additional cut-base charge will apply.

Available for Framed Series cabinets.

Invert Tall Pantry Frame



MOD# INVERT FRAME-TALL



Using a standard tall pantry, Fabuwood can invert the frame and doors to have the tall door on the top and the short door on the bottom, using an added groove to adjust the fixed shelf height.

Available for Framed Series cabinets.

Create Sink Base Cabinet



MOD# REMOVE-DRAWER

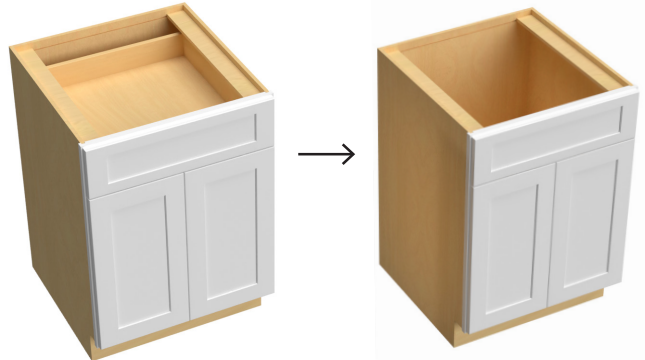

Available for Framed & Frameless Series cabinets. To modify a base cabinet into a sink base, the drawer box and slides will be removed. The drawer front is then attached to the frame as a false drawer front.

Create Peninsula Cabinet



MOD# PEN-CABINET



A peninsula cabinet can be created from two wall and/or base cabinets.

Fabuwood will create a peninsula using any cabinets as long the peninsula side frame is the same size. If it is a full height door on the peninsula side, there will be a 7" apron to cover the drawer box.

Please note: For a No Door Wall Cabinet Peninsula, wood shelves will be provided instead of glass shelves.

Available for Framed Series cabinets.

Remove Floor of Cabinet

MOD# REMOVE-FLOOR



To remove the floor, the bottom panel, bottom rail, and toe kick (if applicable) are removed from frame. Bottom panel grooves are filled in and support is added for shipping.

Note: Cabinets with full center stile are not eligible for this modification.

Available for Framed Series Cabinets.

Install Roll-Out Drawers Side-by-Side in Cabinet

MOD# ROD-SPECIAL



Modify Double Door cabinets to have Roll-Out Drawers Installed Side-by-side. EZ-Pricing will apply this modification automatically for Framed Series 36" - 48" Base & Sink Base cabinets.

Please note: Custom quote required for additional sizes.

Available for Framed Series cabinets.

Install a Drawer in the Toe-Kick of a Base Cabinet

MOD# TK DRAWER

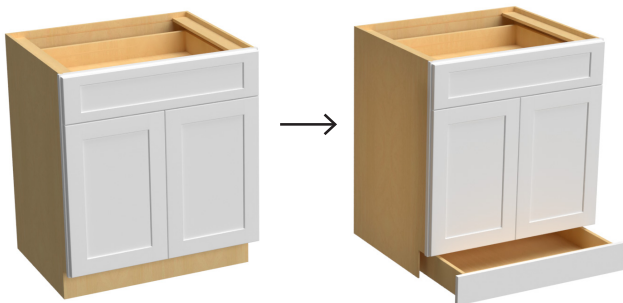

Fabuwood can modify any base cabinet with a toe kick drawer allowing for additional storage.

Available for Framed & Frameless Series cabinets.

Create Curio Wall Cabinet



Fabuwood can create a curio cabinet by replacing a 12" wide face frame and mitering the front frame.

Please note:

- Glass doors can be added to the front and side of the cabinet and can be ordered separately.
- Customer to specify if they would like the Curio Side to be a fixed or working door.
- Custom quote required.

Available for Framed Series cabinets.

Stacked Cabinets



Please note:
Customer can specify any exposed sides to ensure skin application.
Custom quote required.
Available for Framed Series cabinets.

Create Blind Cabinet



Fabuwood can create a blind cabinet by using any double door base or wall cabinet by removing one door and adding a wide center stile.
Please note: Custom quote required.
Available for Framed & Frameless Series cabinets.

Create Wall Open Shelf from No-Door Wall Cabinet

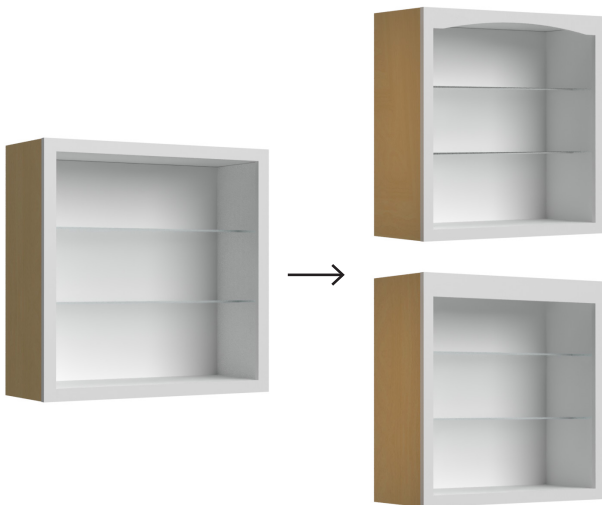

Fabuwood can add an arched or straight valance to any wall cabinet. Hinge holes can be filled upon request.
Please note: Custom quote required.
Available for Framed Series cabinets.

Arched Toe Kick Valance



An arched flushed toe kick can be created upon request.
Please note: Custom quote required.
Available for Framed Series cabinets.

Finish Interior of Cabinet with Walnut

MOD# CHOOSE-INTERIOR



Fabwood can finish the interior of a cabinet to Walnut Finish.

Available only for Framed Allure Series cabinets. Not available for WOS or WR/WC/WO cabinets

Choose Interior of Cabinet

MOD# CHOOSE-INTERIOR



Finish full interior of cabinet to selected color or stain. Customer can choose from Signature or Designer.

Available only for Framed Series cabinets. Not available for WOS, WR/WC/WO cabinets

Frameless Finished Ends

MOD# FINISHED-END



We've added a laminate skin to the left, right, or both sides of applicable cabinets. Finished ends will add less than 1/16" to the total width for a simple, clean, seamless look.

Please note: The front edge band will cover the skin on the sides only. The top and bottom edge band will remain white linen.

Paint/Stain Interior of Cabinet to Match Exterior

MOD# MATCH-INTERIOR



Fabwood can finish the interior of any cabinet to match the exterior color.

Available for Framed & Frameless Series cabinets.

Matching Color Edge-Band



MOD# EBAND-MATCH BOX



Upgrade your Frameless Series cabinets with a Matching Color Edge-Band that matches your selected door finish for a seamless custom look.

Matching Color Edge-Band



MOD# EBAND-MATCH SHELF



Upgrade the adjustable shelves in Frameless Series cabinets with a matching edge-band for a cohesive finish.

Two Tone Hoods



Available for Framed Allure Series chimney-style hoods, including Euro, Farmhouse, Signature, and Curved Artisan. The 2-Tone Finish modification lets dealers add an accent finish to the hood's base, chimney, moldings, & valance.

Create Two-Drawer Base from Three-Drawer Base



Available for Framed Series cabinets.

Relocate the horizontal rails. Add a full set of custom or stock sized doors.

Please note: Custom quote required.

Custom Drawer Base Cabinets are available to enter via EZ-Pricing Online for Framed Allure, Frameless Illume & Ovela Series cabinets.

Split Top Drawer of Drawer Base Cabinet



Fabuwood can customize a drawer base with two drawers on top, side by side by adding a center stile to the face frame.

Please note: Custom quote required.

Available for Framed & Frameless Series Cabinets.

Create Four-Drawer Base from Three-Drawer Base



Available for Framed Series Cabinets.

Add and relocate the horizontal rails. Add a full set of 2 drawer boxes and drawer fronts, and 1 set of slides.

Please note: Custom quote required.

Custom Drawer Base Cabinets are available to enter via EZ-Pricing Online for Framed Allure, Frameless Illume & Ovela Series cabinets.

Create Farm Sink Base



Available for Framed & Frameless Series cabinets.

To create a farm sink base, a closed front panel will be added above the doors and a door set from an 18" H wall cabinet will be used.

Please note: Custom quote required.

Create Custom Knee Drawer



Available for Framed & Frameless Series Cabinets.

Fabuwood can create a single or double knee drawer upon request.

Please note: Custom quote required.

Create 42" Diagonal Sink Base



Fabuwood can create any custom size diagonal cabinet. To create a DSB42", the door set used is a B24 leaving the front angle to be 25-1/2".

Please note: Custom quote required.

Oversized Tall Filler

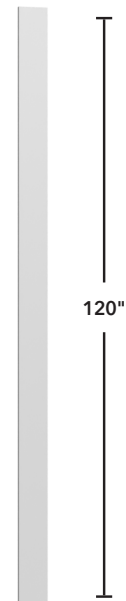

Fabuwood can create a 3" or 6" filler up to 120"H.

Please note: Custom quote required.

Available for Frameless Series Cabinets.

Oversized 1/2" or 3/4" Plywood Panel

SKU# PLY-1/2 48X120, PLY-3/4 48X120

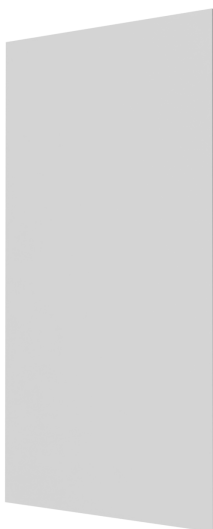

Create an oversized 1/4" panel in any size up to 48" x 120".

Available for Framed Series cabinets.

Oversized Refrigerator End Panel & Refrigerator Panel with Return



SKU# REP30120 , REP30120 X 1 1/2 , REP30120 X 3

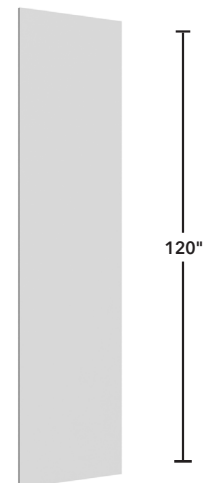

Fabuwood can create an oversized REP 3/4" thick up to 48" x 120", edge banding the two long sides.

Available for Framed Series Cabinets.

Connect Door Set with Dowels



MOD# CONNECT DOORS

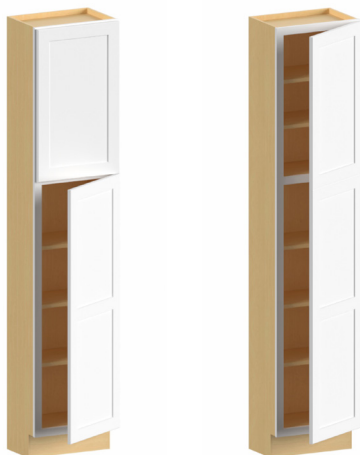

Connect tall pantry door sets with metal dowels only; no additional hardware needed. Available with a spacer for a subtle gap or without a spacer for a flush finish.

Please note: For a door with drawer front, or additional configurations, a Custom Quote is required.

Available for Framed & Frameless Series cabinets.

Dishwasher Return Increase Depth Modification



MOD# INCREASE-PANEL

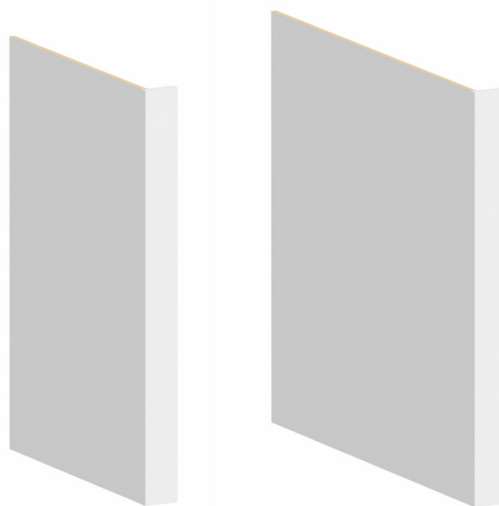

Increase depth of Dishwasher Return Panel (DWR) in 1/4" increments, up to a maximum of 48".

Available for Framed & Frameless Series cabinets.

Cut Out Center Panel of Door for Glass Insert

MOD# CUT-DOOR

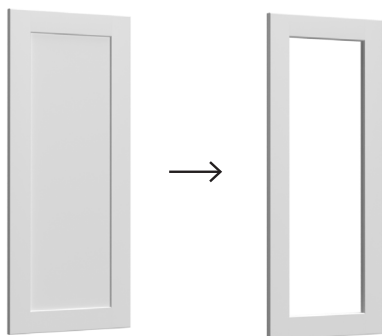

Center panels of doors can be cut out to prepare for glass inserts. Customization includes refinishing the cut edges and a rubber gasket for installation of a 1/8" thick glass is included.

Please note: Glass is not supplied.

Available for Framed Series cabinets. Luna/Echo/Luxe Door Styles: available via Custom Doors only.

Door(s) will be shipped loose; hinges will come installed on the cabinet.

Create Chase in a Roll-Out Drawer

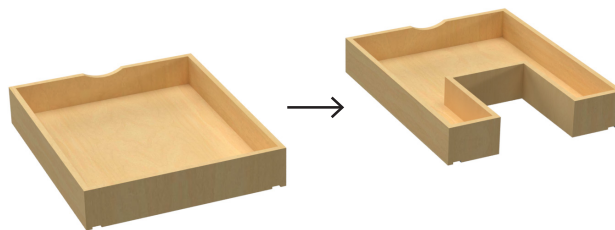

Fabuwood will modify the drawer box to have a Pipe chase for plumbing.

Please note: Customer must provide drawing. Custom quote required.

Framed & Frameless Series cabinets.

Customization Gallery







KEY	1	FD18	8	W3642
	2	CLM-BASE	9	CUSTOM DECO PANEL
	3	CUSTOM WD1866 (MATCH INTERIOR)	10	STKM-8
	4	CUSTOM 72" WALL ORGANIZER	11	STRM-8, CM-3
	5	W3630	12	TK8
	6	B36 (CUT-CASE, RECESS-TK)	13	CUSTOM BUN FEET PAINTED BY FABUWOOD
	7	CUSTOM BOOKCASE (WALNUT INTERIOR)		

	<h1>Kitchen Callouts</h1>	DOOR STYLE(S)
		<i>Fusion</i> Baby Blue Eyes SW9070



KEY	1	CUSTOM DECO PANEL (FRIDGE)	10	B12FD
	2	TP182484 (CUSTOM DOOR, MERIVO ROLLOUT)	11	CUSTOM WALL 421824LU
	3	B09 (CUT-WIDTH, CUSTOM ACC)	12	W2142 (ELEMENT DESIGN GLASS DOOR)
	4	CUSTOM DECO PANEL (DISHWASHER)	13	W3015LU, W3030
	5	B27FD (UNDER SINK MAT)	14	WP-W42
	6	BLB42/45 FD (BPO-BLB42/45-R ILLUME)	15	TK8
	7	B21 (ROD-B21)	16	PAN-3/4, EDGE BAND
	8	BF3	17	STRM-8, VST-6
	9	B21 (TC21 ILLUME)	18	WP-BASE

	<h1>Kitchen Callouts</h1>	DOOR STYLE(S)
		<p><i>Catalina</i> Ice Cream & Matte Black</p>



KEY	1	B24 (HAMPER, DRYING RACK DRAWER)	7	W2430 (WP-BASE)
	2	TP242490 (CUT-HEIGHT, CUSTOM DOOR LU)	8	DBS36 (CUT BASE) DRAWER BENCH SEAT
	3	W2436 (INCREASE)	9	W3636 (INCREASE)
	4	W421224LU (CUT-WIDTH, CUSTOM DOOR)	10	CREATE RETURN WALL
	5	SB30 (UVTCP0-30 BLUM)	11	CUSTOM CLM-OS
	6	CUSTOM VALANCE		

	<h1 style="margin: 0;">Kitchen Callouts</h1>	<p style="margin: 0;">DOOR STYLE(S)</p> <p style="margin: 0;"><i>Fusion</i> Odessa Pink HC-59</p>
---	--	---



KEY	1	CLM-96	6	CUSTOM WALL CABINET
	2	DBS36 DRAWER BENCH SEAT	7	CM-7
	3	CUSTOM WALL CABINET	8	TK8
	4	W362424	9	CLM
	5	DB36 (CUT BASE-HEIGHT)		

	<h1>Kitchen Callouts</h1>	DOOR STYLE(S)
		<i>Fusion</i> Pistachio Green



KEY	1	B36FD	4	CUSTOM WALL CABINET
	2	DB36-2	5	MATCH INTERIOR & CUSTOM LAMINATE
	3	CUSTOM WALL CABINET		

	<h1>Kitchen Callouts</h1>	DOOR STYLE(S)
		<i>Nexus Graphite Black</i>

Two-Tone Hood

Finish Modification



Signature Traditional Hood
Oyster Base with Kona moldings and valance



Artisan Curved Hood
Timber Base and valance
with Pitch Black moldings

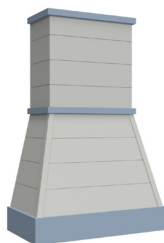

Farmhouse Range Hood
Cloud White Base with Izel
Blue moldings and valance



Signature Traditional Hood
Kona Base with Graphite
Black moldings and valance

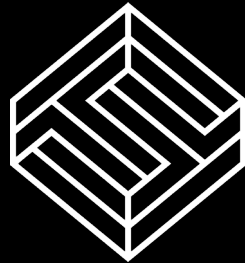



∅ At Fabuwood, we prioritize sustainability through energy efficiency, waste reduction, and eco-friendly practices, creating a healthier environment for our employees, customers, and community.

Disclaimer: Images shown may include digital renderings and are intended for illustrative purposes only. Actual product appearance, including color, texture, and finish, may vary. We strongly recommend reviewing a physical sample prior to placing an order. For complete product specifications and availability, please consult the Spec Book.

Published February 2026

